

AMERSHAM COURT

SOUTHSEA | HAMPSHIRE | PO4 0NX



£250,000
Leasehold

- Exceptional Ground Floor Apartment
- Positioned within Craneswater Park
- Two Double Bedrooms : Modern Shower Room
- Spacious Kitchen with Integrated Appliances
- Walking Distance to Shops and Seafront
- Allocated Parking
- Gas Central Heating : Double Glazing Throughout
- Viewing Advised!



In Brief

Step into a world of contemporary elegance and effortless living. This exquisite 2-bedroom apartment, spanning 72 square meters, is a testament to smart design and modern luxury.

The heart of the home, a stunning open-concept living and dining area, welcomes you with its serene blue walls and warm wood flooring, creating an atmosphere of relaxation and sophistication. The state-of-the-art kitchen is a culinary enthusiast's dream, featuring sleek white cabinetry, high-end appliances, and eye-catching patterned floor tiles that add a touch of personality. Whether you're preparing a gourmet meal or enjoying a quick breakfast, this space inspires creativity and conversation. The bedrooms are a tranquil retreat, adorned with ample natural light. A stylish pendant light adds a touch of glamour, while built-in storage ensures a clutter-free sanctuary. Indulge in the spa-like bathroom, where intricate floor tiles and modern fixtures create a luxurious ambiance. The glass-enclosed shower and sleek finishes elevate your daily routine to a pampering experience.

Throughout the home, thoughtful details like the unique light fixtures, carefully chosen artwork, and nautical accents infuse character and charm. This apartment isn't just a living space – it's an invitation to embrace a lifestyle of comfort, style, and endless possibilities.

£250,000

KEY FACTS

Tenure: Leasehold

Term: 138 years remaining

Ground Rent: None

Service Charge: £1,820.00 per annum

EPC Rating: 'C'

Council Tax Band: 'C'



AMERSHAM COURT

SOUTHSEA | HAMPSHIRE | PO4 0NX



Amersham Court, Craneswater Park, Southsea

Approximate Gross Internal Area = 71.9 sq m / 774 sq ft

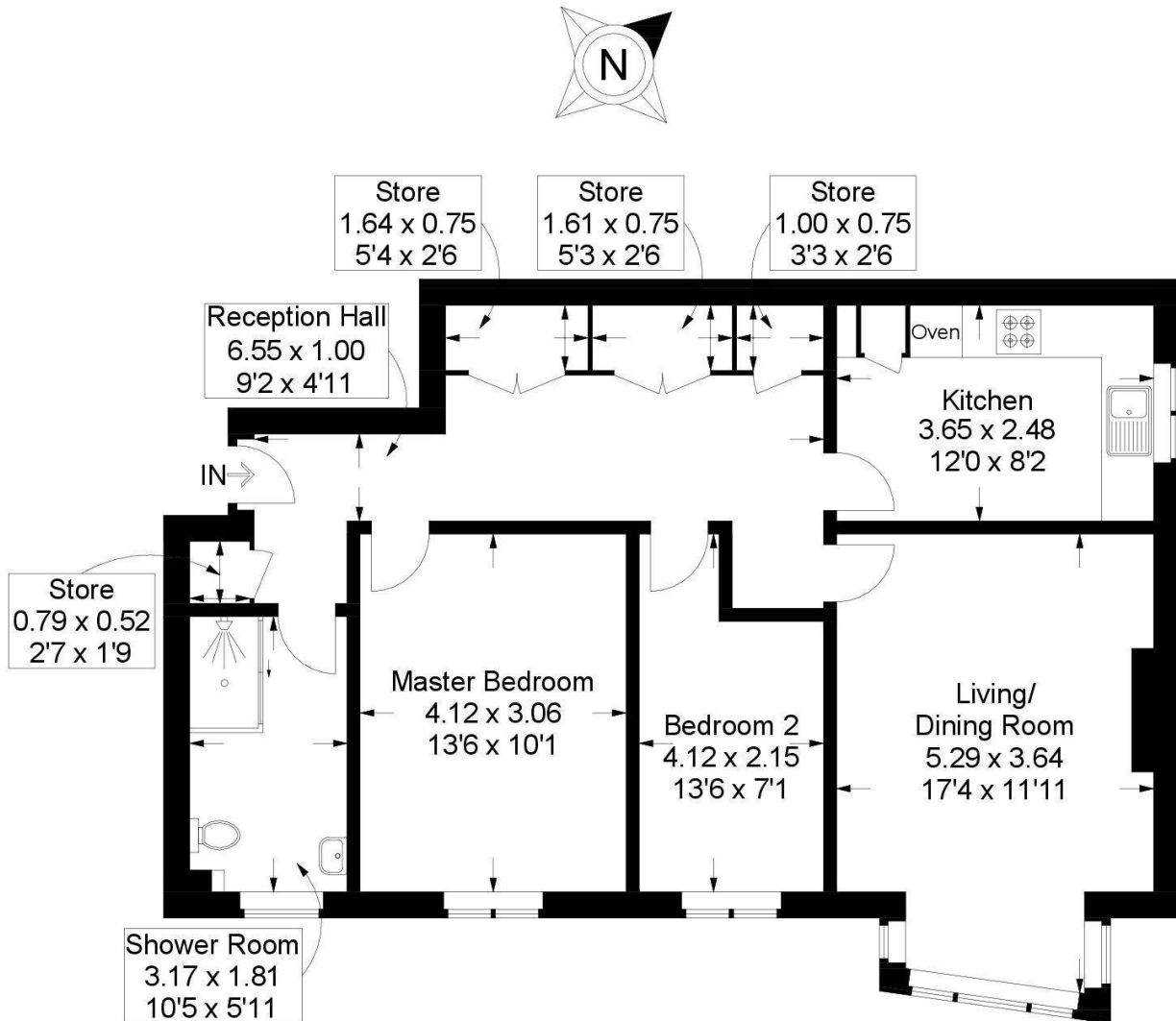

Ground Floor

This plan is for layout guidance only. Not drawn to scale unless stated. Windows and door openings are approximate. Whilst every care is taken in the preparation of this plan, please check all dimensions, shapes and compass bearings before making any decisions reliant upon them.

Southsea
Sales & Lettings
7/9 Stanley Street,
Southsea, PO5 2DS
Tel: 023 9281 5221

Old Portsmouth & Gunwharf Quays
Sales & Lettings
The Seagull, 13 Broad Street,
Old Portsmouth, PO1 2JD
Tel: 023 9281 5221

Drayton & Out of Town
Sales & Lettings
139 Havant Road,
Drayton, PO6 2AA
Tel: 023 9221 0101

London
Sales & Lettings
Mayfair Office, Cashel House,
15 Thayer Street, W1U 3JT
Tel: 0870 112 7099

Southsea
Admin Centre
12 Marmion Road,
Southsea, PO5 2BA
Tel: 023 9282 2300

www.fryandkent.com